

RQX-XT-KP WIRING INSTRUCTIONS

- To wire the DTMF Keypad to the controlling device, the Callbox metal faceplate must be removed. Use the T-25 Security Torx-Head driver (included with the Callbox), remove the (4) large Torx screws securing the faceplate to the Callbox case.



- Refer to the Enforcer Outdoor Stand-Alone Weatherproof Keypads Manual (included with the Ritron RQX-XT-KP Callbox) to connect the DTMF Keypad to the controlling device.

IMPORTANT! – DO NOT connect the keypad wire assembly (Fig.-1) to the RQX-XT 6-conductor cable assembly (Fig.-2). The keypad wire assembly should be wired directly to the controlling device.

Refer to the Enforcer Outdoor Stand-Alone Weatherproof Keypads Manual that is included in this package for wiring connections and instructions.

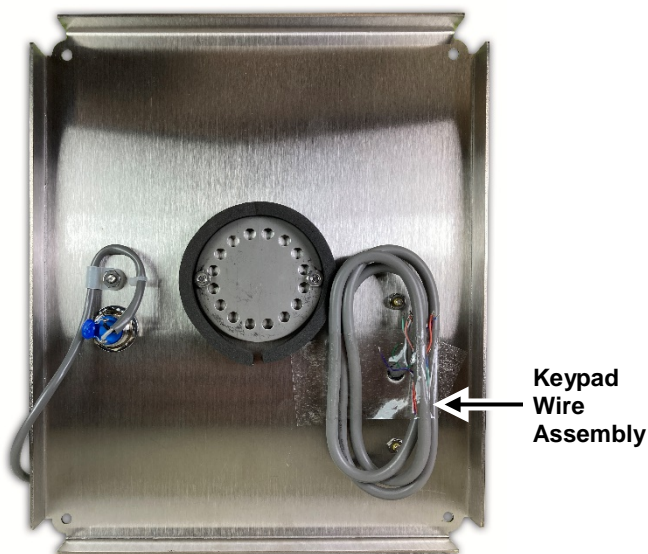

Fig.-1 – Keypad Wire Assembly

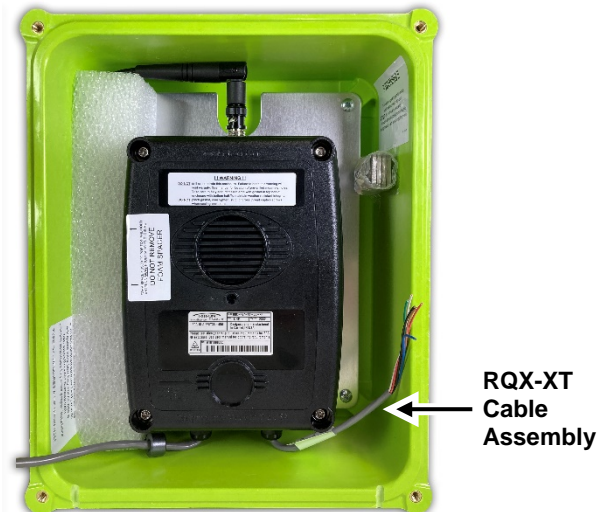

Fig.-2 – RQX-XT Cable Assembly